

FOR LEASE

301 Halton Rd Suites I & J | Greenville, SC 29607

FOR LEASE:
Medical Office Space

EXECUTIVE SUMMARY:

Space for Lease Summary:

Space Available:	1,585 SF
Space Type:	Medical Office
Asking Lease Rate:	\$14.50
Lease Type:	NNN
Available Date:	Available Now
Former Use:	Medical Office

Medical Office Space Highlights:

- ❖ Already built out, move-in ready medical office space, with waiting area and multiple examination rooms
- ❖ Located in popular retail and office corridor between Haywood Rd and Woodruff Rd
- ❖ Population of 53,000 within 3 Miles expected to grow 8% between 2020-2025
- ❖ Building Signage Available



Graham Mullikin
(864)-704-4490
graham@stoneandcompany.net
1100A Rutherford Rd.
Greenville, SC 29609

Gordon Huey
(843)-330-0415
gordon@stoneandcompany.net
1100A Rutherford Rd.
Greenville, SC 29609



STONE & COMPANY
— Real Estate —

FOR LEASE

301 Halton Rd Suites I & J | Greenville, SC 29607

FOR Lease:
Medical/Office Space

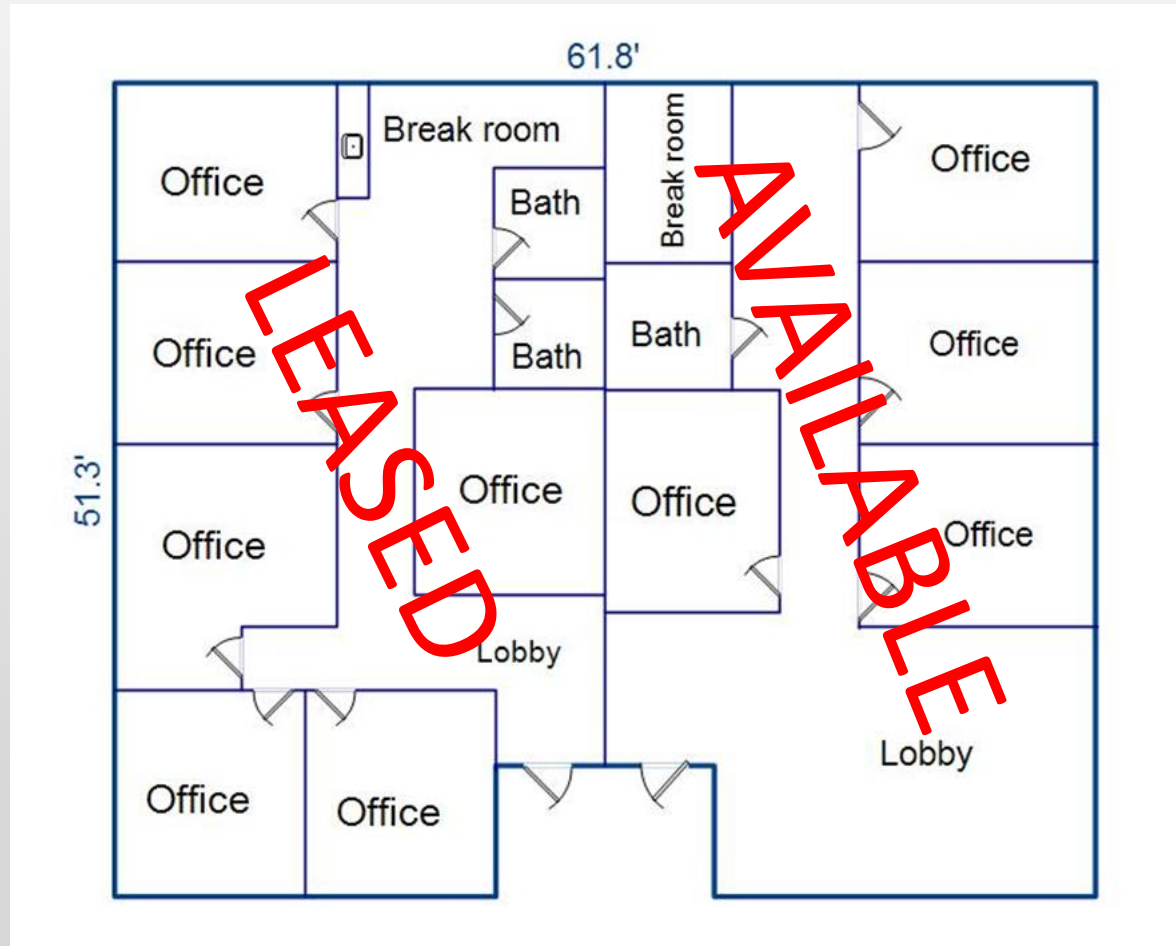
Current Floor Plan:



Graham Mullikin
(864)-704-4490
graham@stoneandcompany.net
1100A Rutherford Rd.
Greenville, SC 29609

Gordon Huey
(843)-330-0415
gordon@stoneandcompany.net
1100A Rutherford Rd.
Greenville, SC 29609